

CITY OF LEBANON  
TAX MAP 131 LOT 1  
VOL. 1349 PG. 608

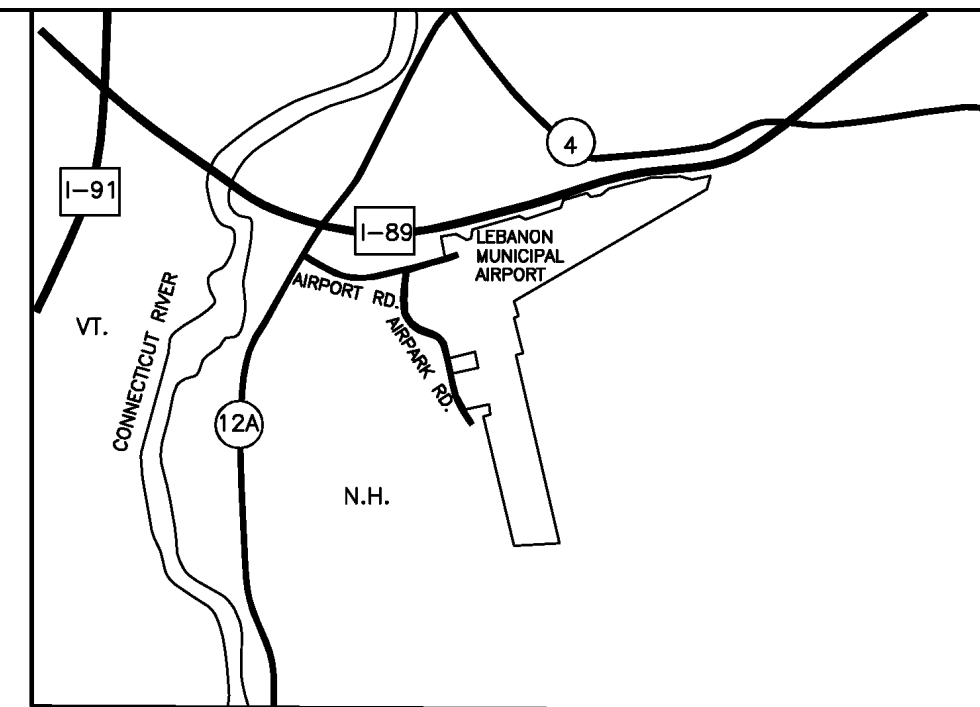

LOCATION MAP

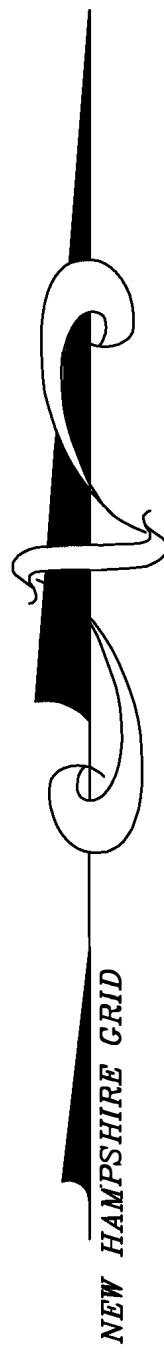
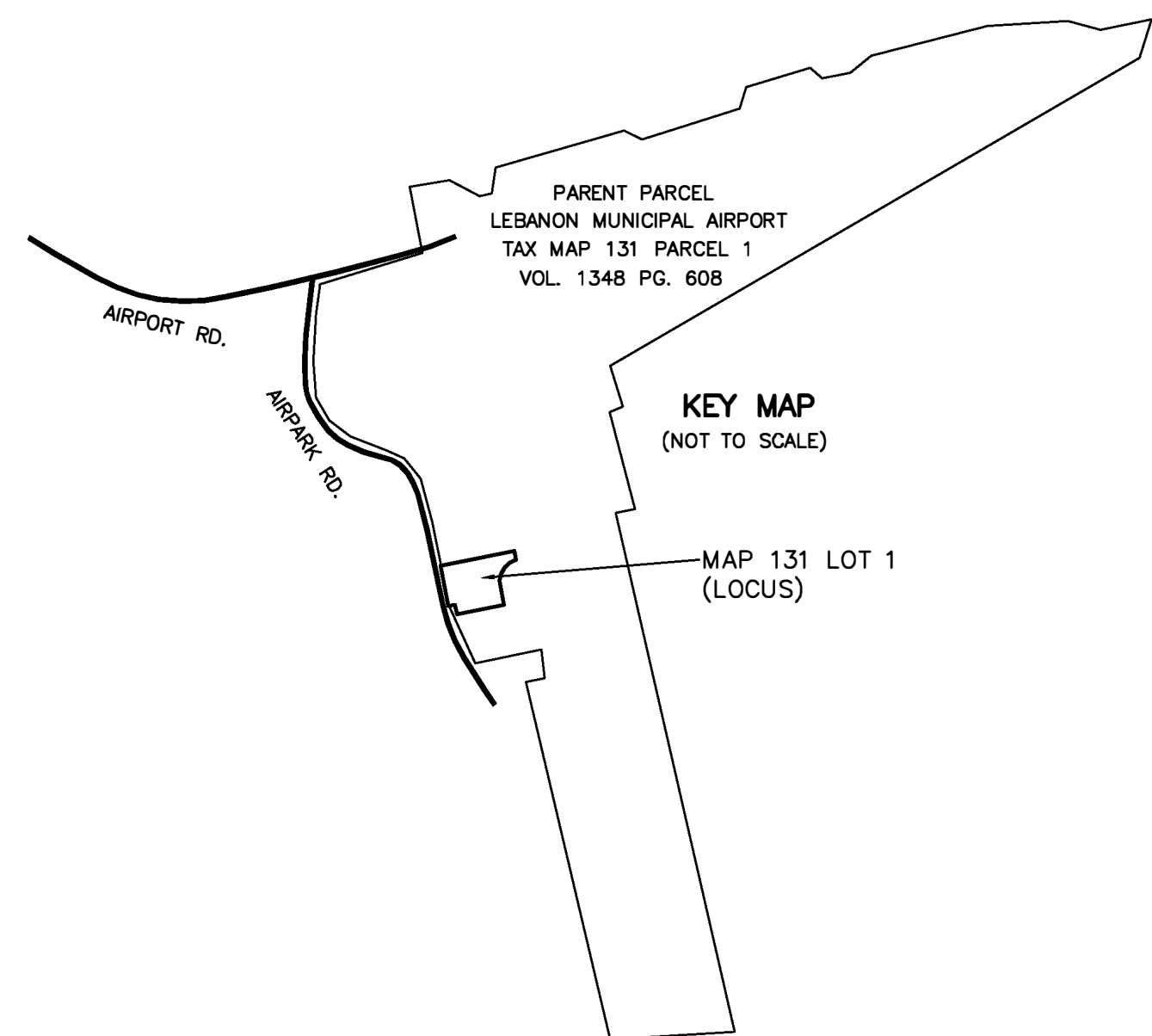

NOTES

1. THE PURPOSE OF THIS PLAT IS TO DEFINE THE LEASE LINES OF PARCELS OF LAND TO BE LEASED TO EXECUTIVE RAMP.
2. METHODS OF SURVEY: STATIC G.P.S., R.T.K. G.P.S. AND THEODOLITE AND E.D.M.
3. BEARINGS ARE IN RELATION TO N.H. GRID NORTH.

LEGEND

- UTILITY POLE
- ☆ LIGHT POLE
- ⊗ FIRE HYDRANT
- ⊕ WATER GATE VALVE
- ⊙ CURB STOP
- C.B. □ CATCH BASIN
- ⊕ DROP INLET
- ⊙ SEWER MANHOLE
- CHAIN LINK FENCE
- ▲ SATELLITE DISH

REFERENCE PLANS

1. "PROPERTY OF LEBANON REGIONAL AIRPORT AUTHORITY - WEST LEBANON, NEW HAMPSHIRE"; DATED AUGUST 1974; PREPARED BY T & M SURVEYS, INC.
2. "RESUBDIVISION OF LEBANON AIRPORT INDUSTRIAL PARK, PHASE 1-A, WEST LEBANON, NEW HAMPSHIRE"; DATED JULY 1987; PREPARED BY T & M SURVEYS, INC., PLAN NO. 4745 G.C.R.D.

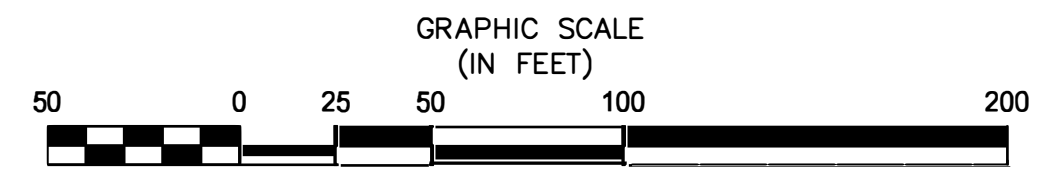

PRELIMINARY

THE SUBDIVISION REGULATIONS OF THE CITY OF LEBANON AND THE NOTICE OF ACTION ARE A PART OF THE PLAT, AND THE APPROVAL OF THIS PLAT REQUIRES THE COMPLETION OF ALL THE REQUIREMENTS OF THE NOTICE OF ACTION AND SAID SUBDIVISION REGULATIONS EXCEPTING ONLY ANY MODIFICATION OR WAIVER SET FORTH IN THE NOTICE OF ACTION.

A PARCEL OF LAND WHICH HAS BEEN REVIEWED AND APPROVED AS PART OF A MINOR SUBDIVISION SHALL NOT BE ELIGIBLE FOR FURTHER SUBDIVISION UNDER THE MINOR SUBDIVISION PROCEDURES FOR A PERIOD OF THREE (3) YEARS FROM THE DATE OF THE MINOR SUBDIVISION APPROVAL.

SURVEYOR'S CERTIFICATION

I CERTIFY THAT THIS PLAN IS THE RESULT OF AN ACTUAL FIELD SURVEY MADE ON THE GROUND AND HAS A MAXIMUM ERROR OF CLOSURE OF ONE PART IN TEN THOUSAND ON ALL PROPERTY LINES WITHIN AND BORDERING THE SUBJECT PROPERTY.

LEBANON MUNICIPAL AIRPORT LEASE LAND	
SUBDIVISION PLAN PREPARED FOR	
CITY OF LEBANON	
TAX MAP 131 LOT 1	
AIRPARK ROAD	
GRAFTON COUNTY, LEBANON, NEW HAMPSHIRE	
PREPARED BY	
PATON LAND SURVEYING	
150 SOUTHRIDGE ST.,	SPRINGFIELD, VT 05156
DATED: JUNE 22, 2019	SCALE: 1"=50'
DRAWN BY JWC	CK'D BY CTP
SURVEYED BY CTP, JC, JR	
PROJ. NO. 2019-281-17	